

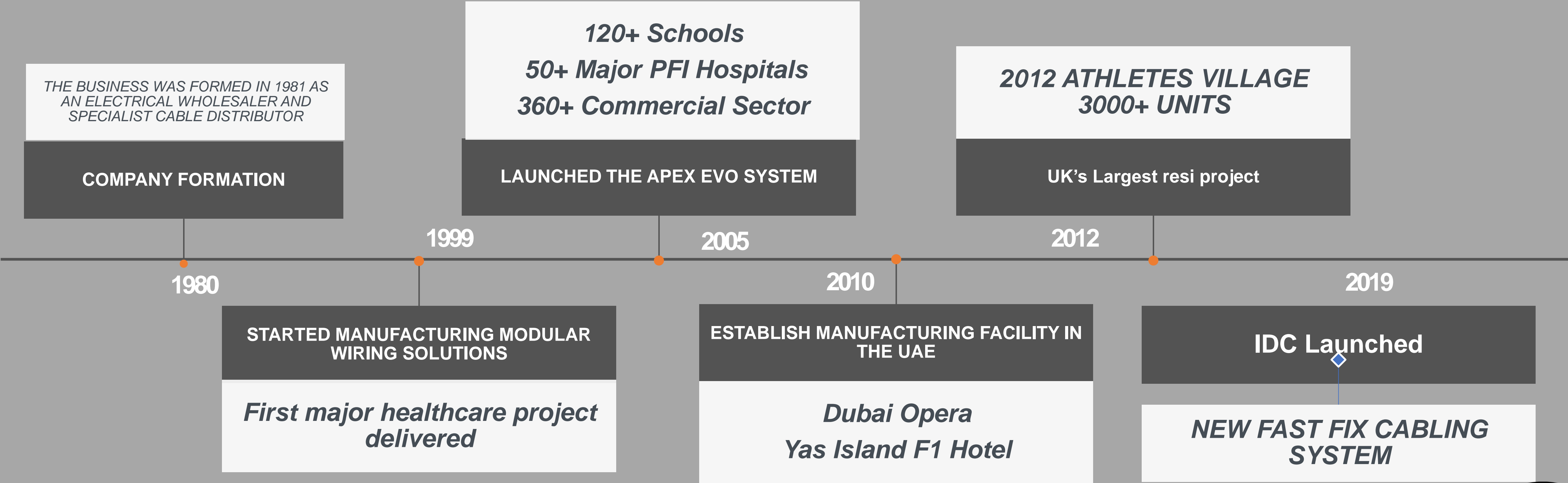

APEX
WIRING
SOLUTIONS

Innovation in MEP

Brief history



Connections without Compromise



Why Modular Wiring?

- ON SITE LABOUR SAVING OF UP TO 70%
- IMPROVED PROGRAM
- IMPROVED QUALITY
- REDUCTION IN ONSITE WASTE
- REDUCE RISK ON SITE
- BRITISH MADE

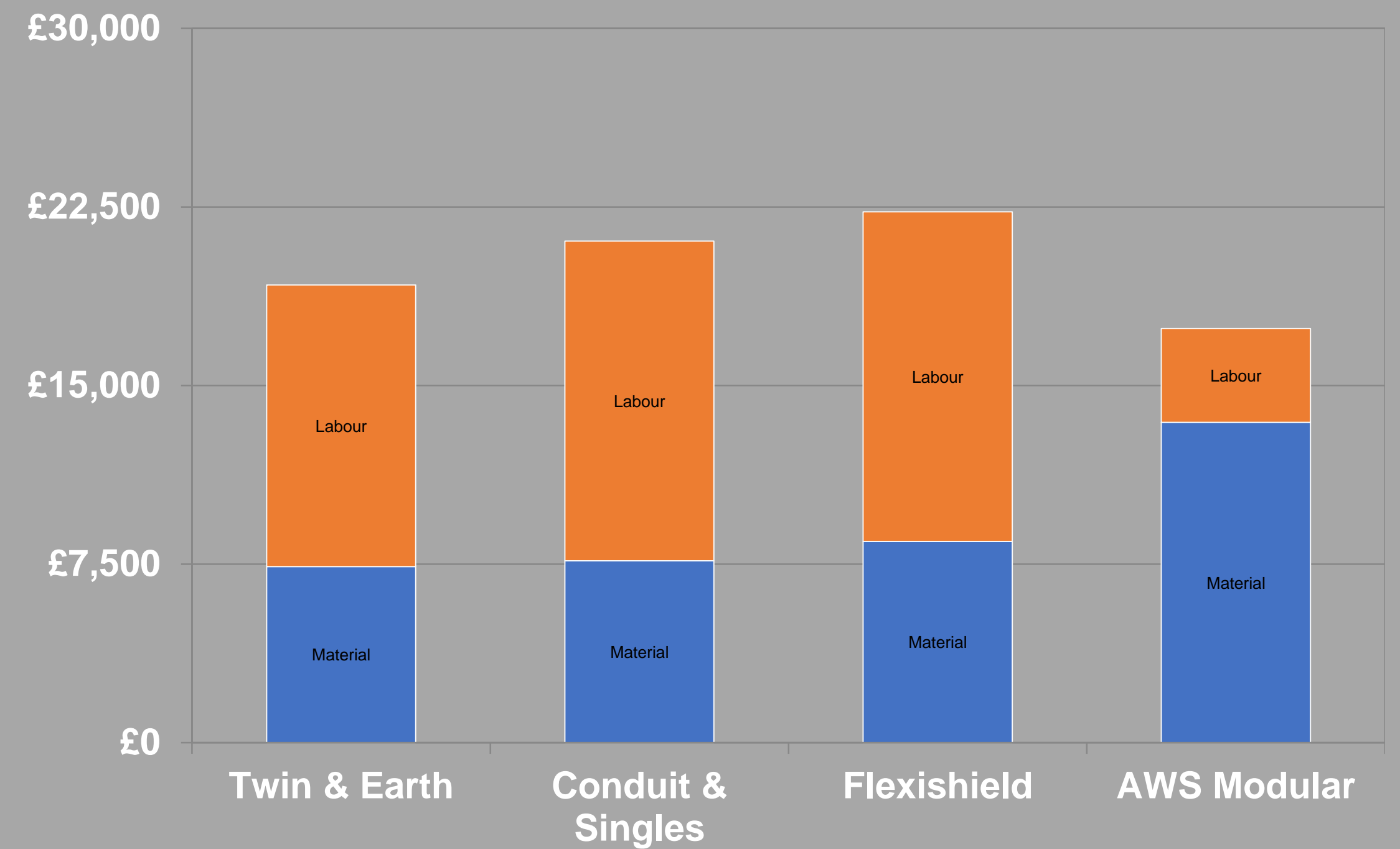

APEX VS TRADITIONAL INSTALLATION

How We Do It

- From DB to final accessory with just a screwdriver
- Simplicity is the key
- Standardisation of products

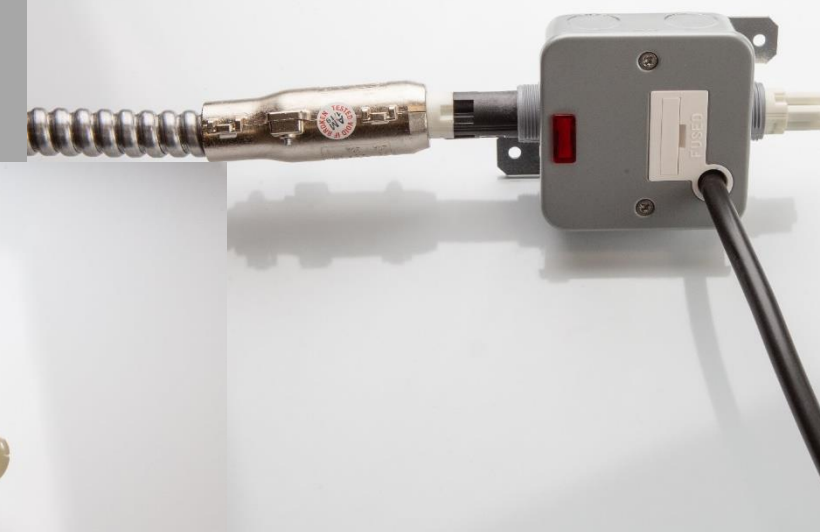
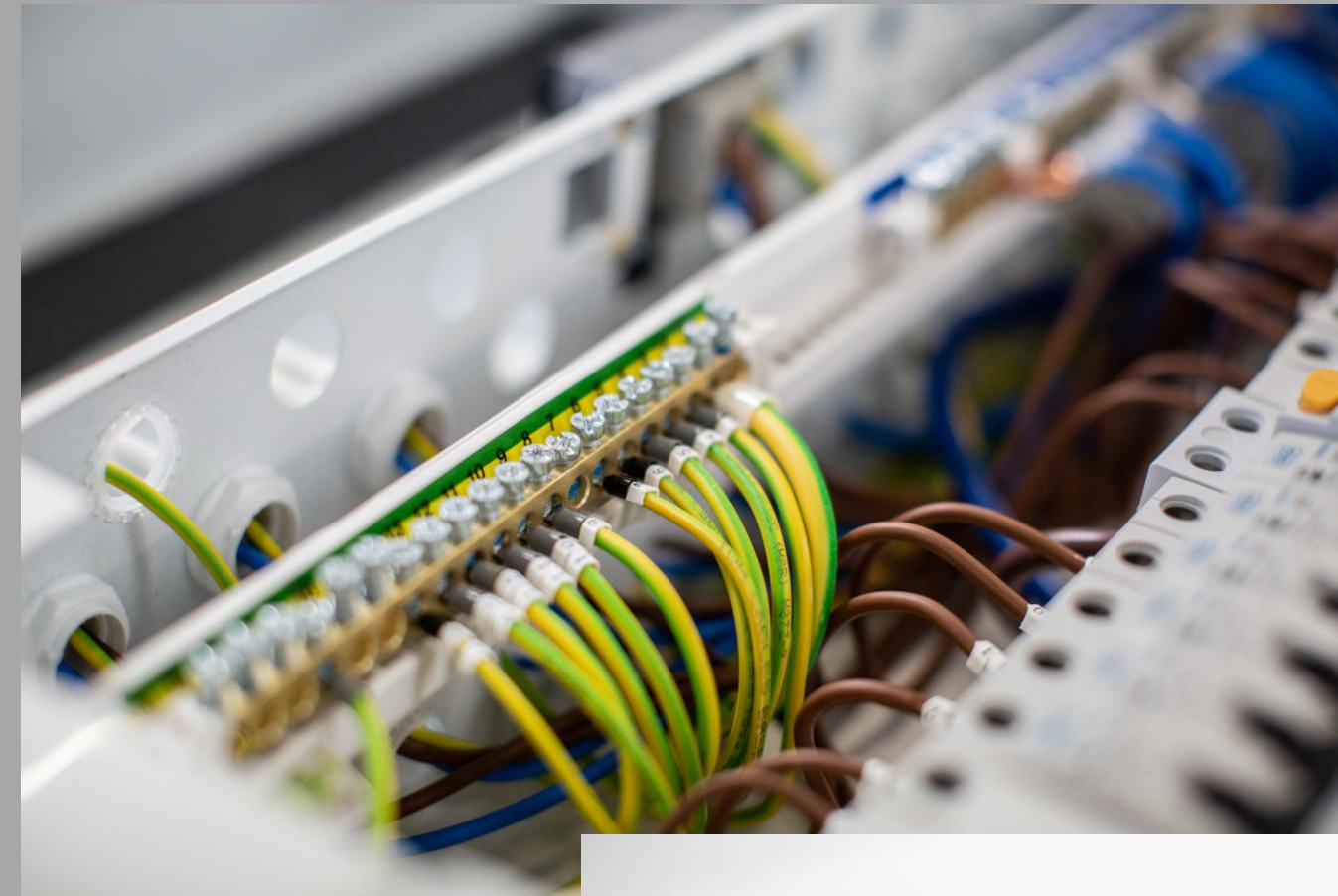

Connections without Compromise



Delivering a successful modular scheme

- Early engagement is vital
- Standardization of parts
- Schematic approval
- Collaboration with other suppliers
- Factor in spare capacity
- Continuity of work areas
- Early installer adoption
- Identify Interfaces – mechanical, lighting...

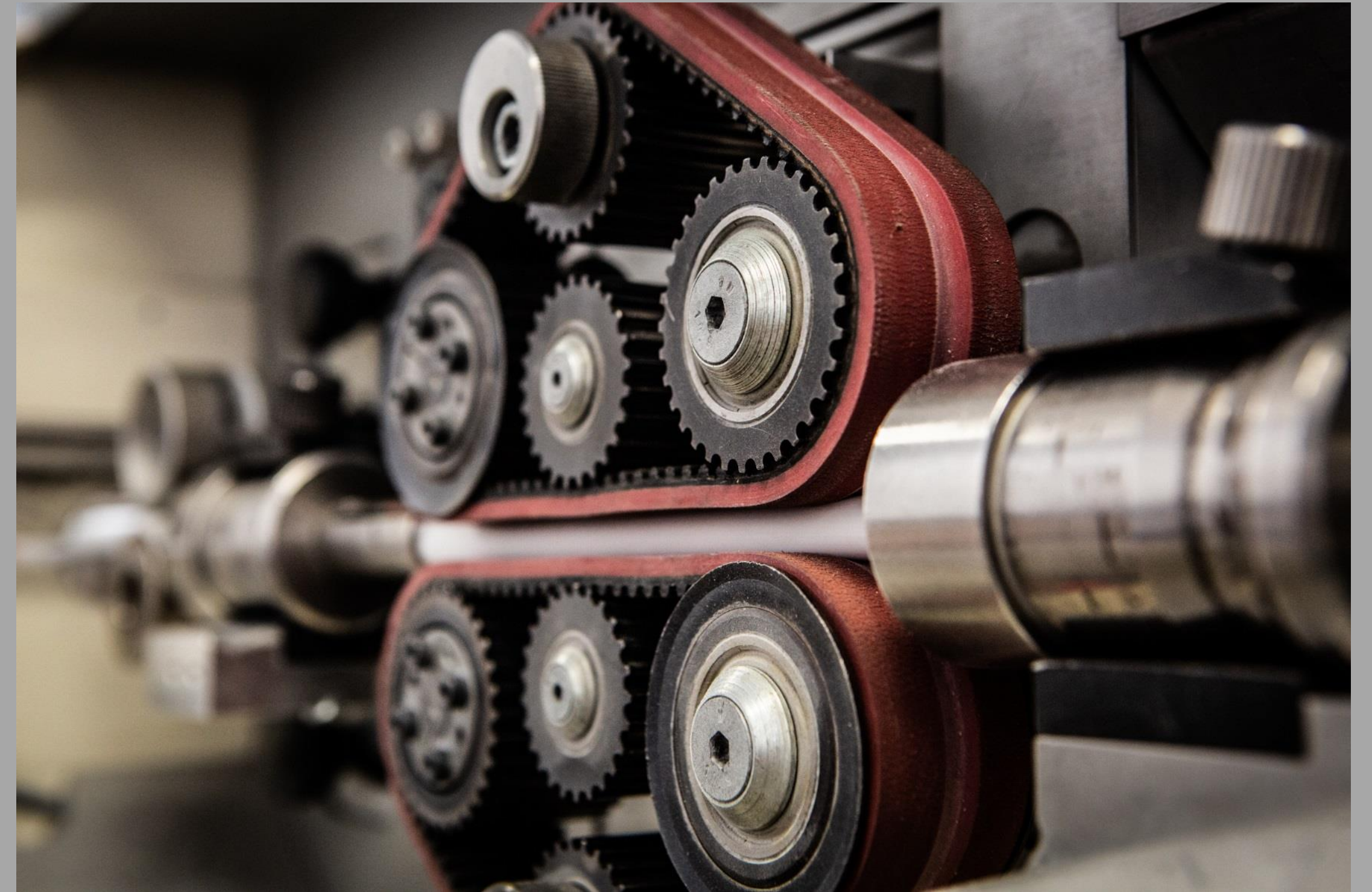

IRR DADO TRUNKING

HOW WE DID IT...

IRR EDINBURGH UNIVERSITY

The engineering design considered dado trunking to all laboratory areas with multiple services and lighting requirements

Artech Lighting in conjunction with Apex Wiring Solutions proposed a solution to factory cut and wire each individual section including corners and angles. We also incorporated a lighting solution which removed the need for desk lamps.

Product was delivered to site on dedicated vehicles ready for simple on site installation and connection.

On site installation time was reduced by around 90 %



PREVIOUS PROJECTS

- **OVER 100 MAJOR HEALTHCARE PROJECTS INCLUDING ROYAL LONDION AND ST BARTS**
- **OVER 300 COMMERCIAL AND FIT OUT PROJECTS INCLUDING HEATHROW AIRPORT AND MANCHESTER AIRPORT**
- **OVER 100 EDUCATION AND SCHOOL PROJECTS**
- **OVER 20000 RESIDENTIAL PROPERTIES WITH OUR SYSTEM INCLUDING ATHLETES VILLAGE LONDON 2012 AND AL ZEINA PROJECT ABU DHABI**
- **OVER 50 MAJOR EXPORT PROJECTS INCLUDING YAS F1 CIRCUIT ABU DHABI**



Connections without Compromise

APEX
WIRING
SOLUTIONS

MANAGED DELIVERY:

- Eliminate waste by removing packaging
- Reduce injury by reducing manual lifting
- Correct product to correct zone or DB location
- Returnable
- Safety features including lockable, steerable wheels, fork-truck lift points



Connections without Compromise

INNOVATION & THE FUTURE

THE BUSINESSES CONTINUES TO GROW AND INNOVATE WITH NEW SOLUTIONS TO AGE OLD PROBLEMS ALWAYS IN OUR MIND.

- INSULATION DISPLACEMENT CONNECTOR SOLUTION FOR RESIDENTIAL
- PUCs PREFABRICATED UTILITY CUPBOARDS
- CONSTANT DEVELOPMENT OF LIGHTING SOLUTIONS

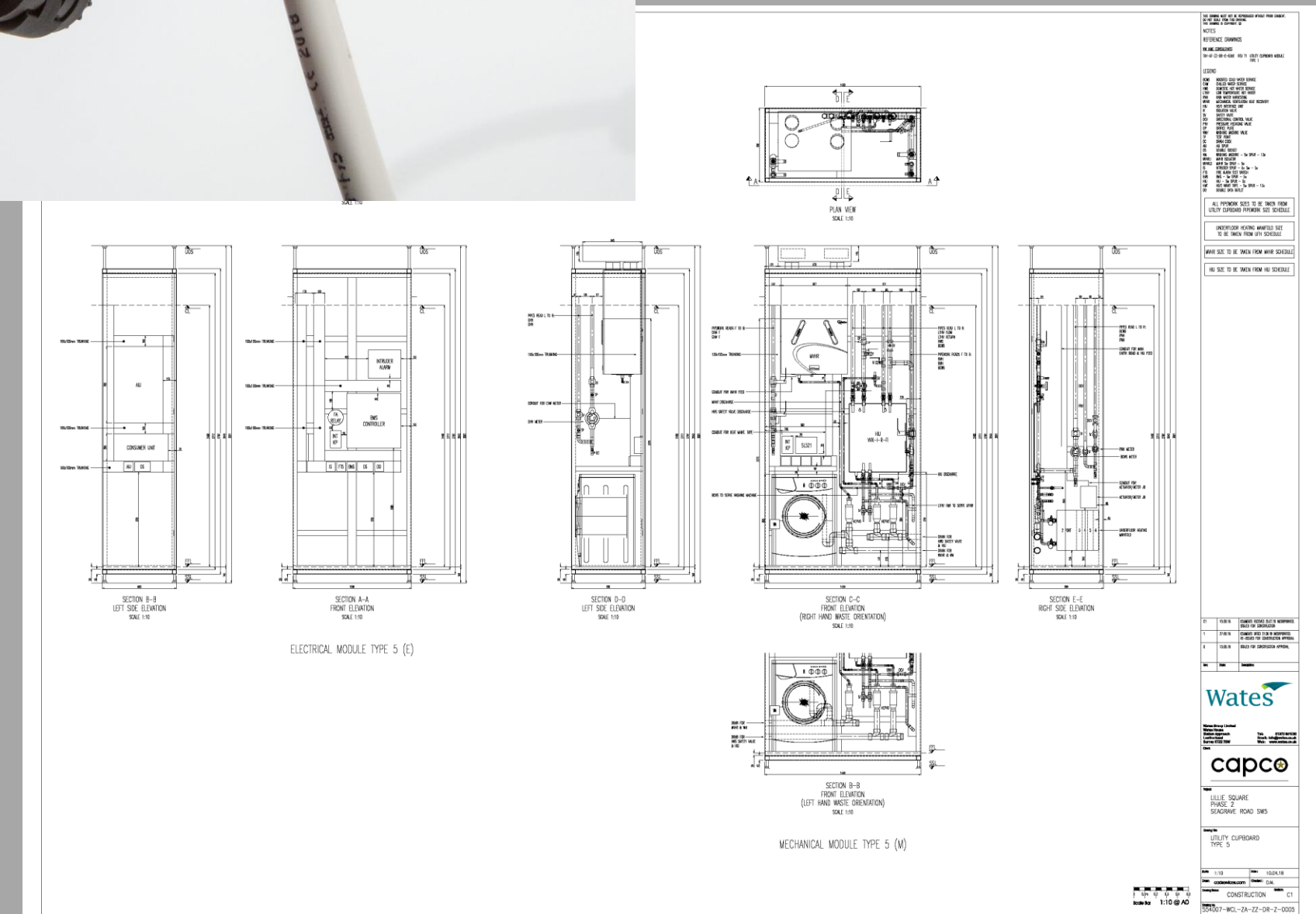

Connections without Compromise

APEX
WIRING
SOLUTIONS

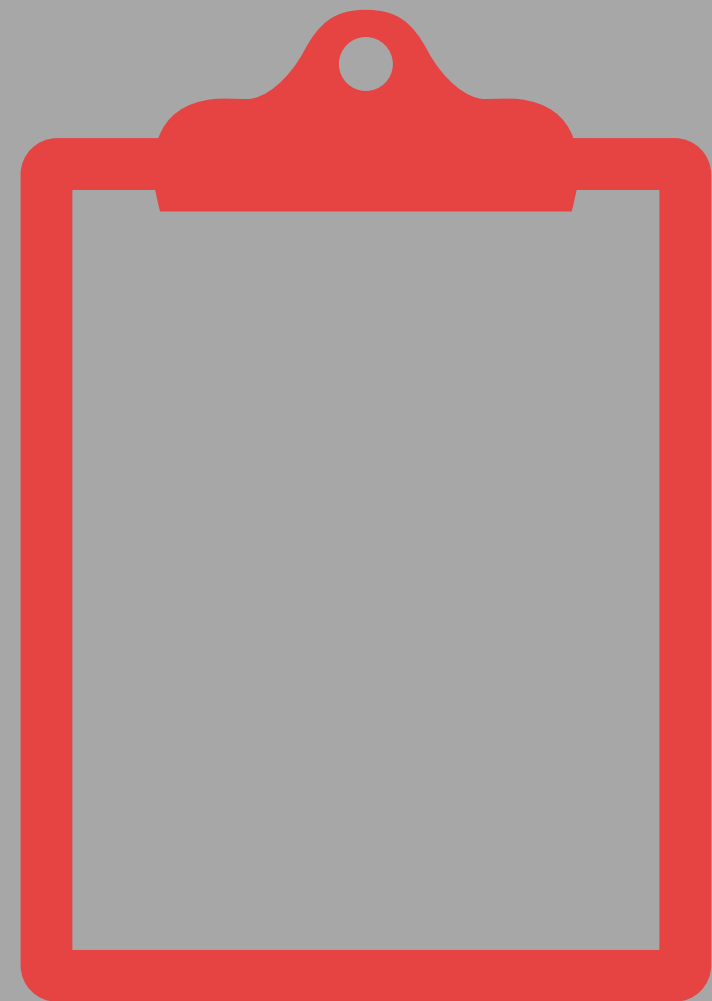

Quality

With a quality conscious approach to manufacturing and design Apex has developed an **enviable** reputation in our chosen markets.



Satisfaction

By listening to **and acting upon** customer feedback we have molded a diverse range of products, which is the envy of the market.



The People

By putting people first we have been able to create an atmosphere that **delivers to the customer** without the distractions of a busy office and factory.



**Making more than products and promises.....
Change the way the world is wired**



**To manufacture the most cost-effective lighting solutions on
the market – providing innovative products, outstanding
quality and delivering the finest service and value to EVERY
customer**



M &E Offsite



The future of construction

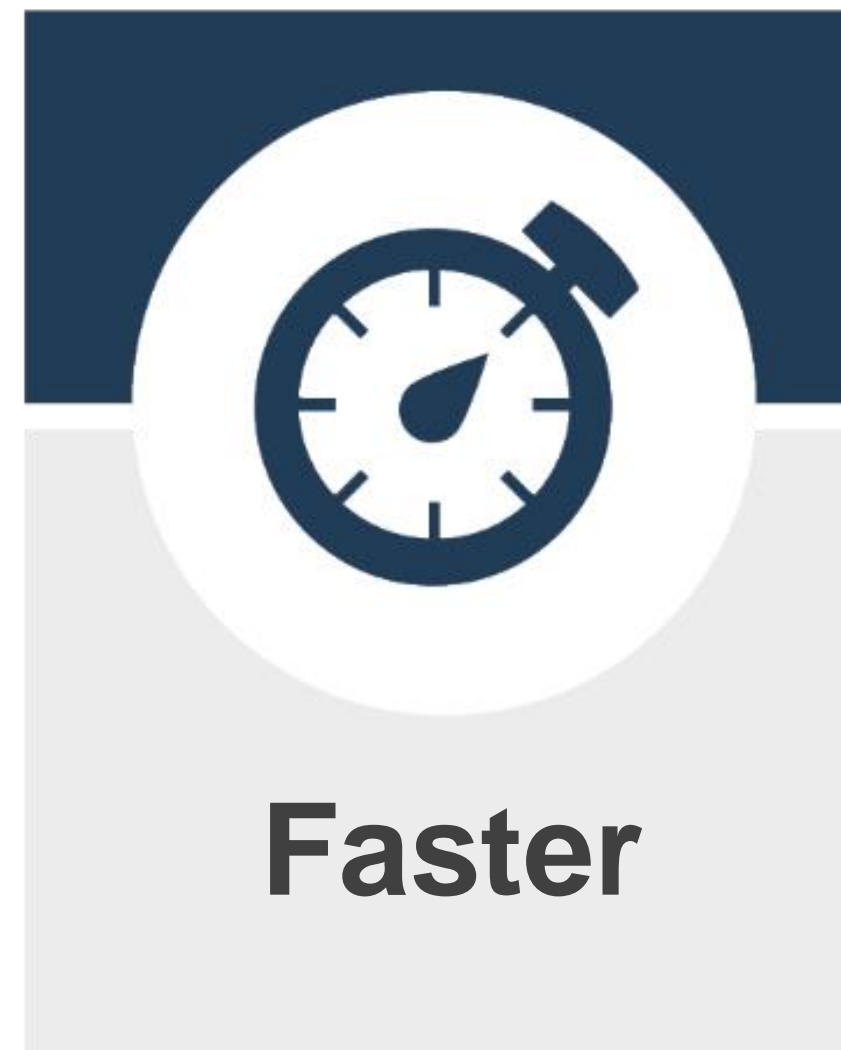
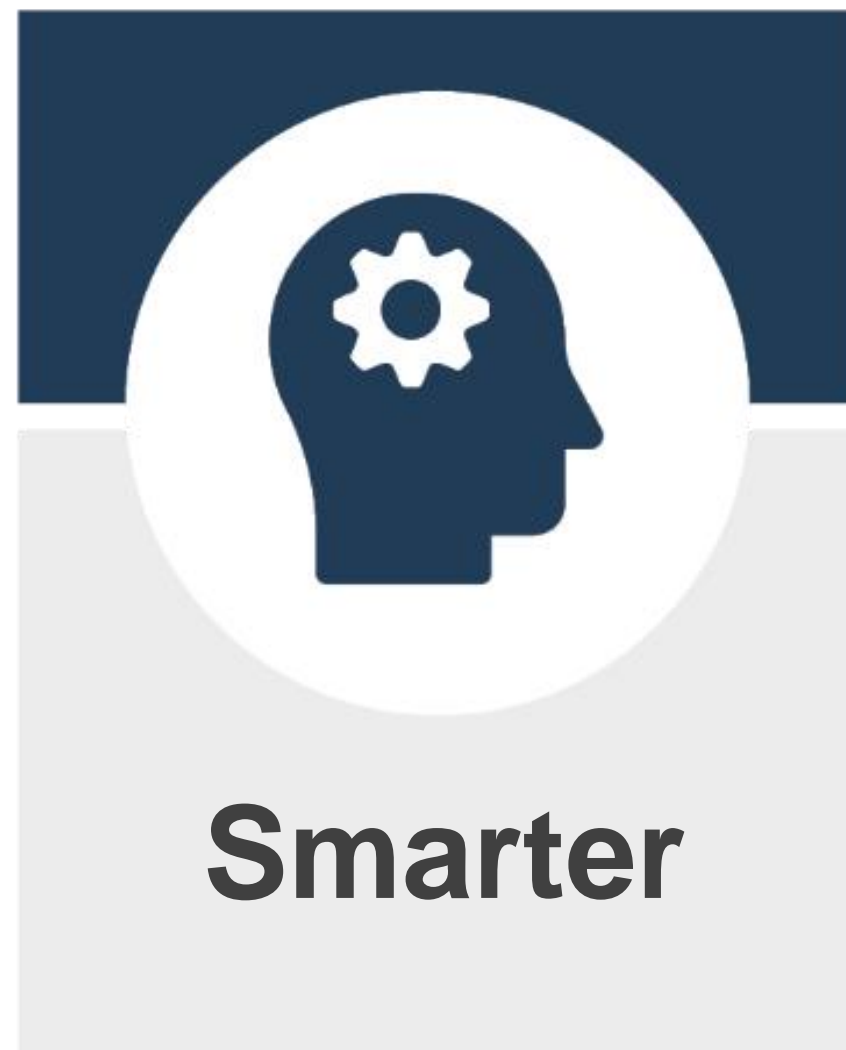
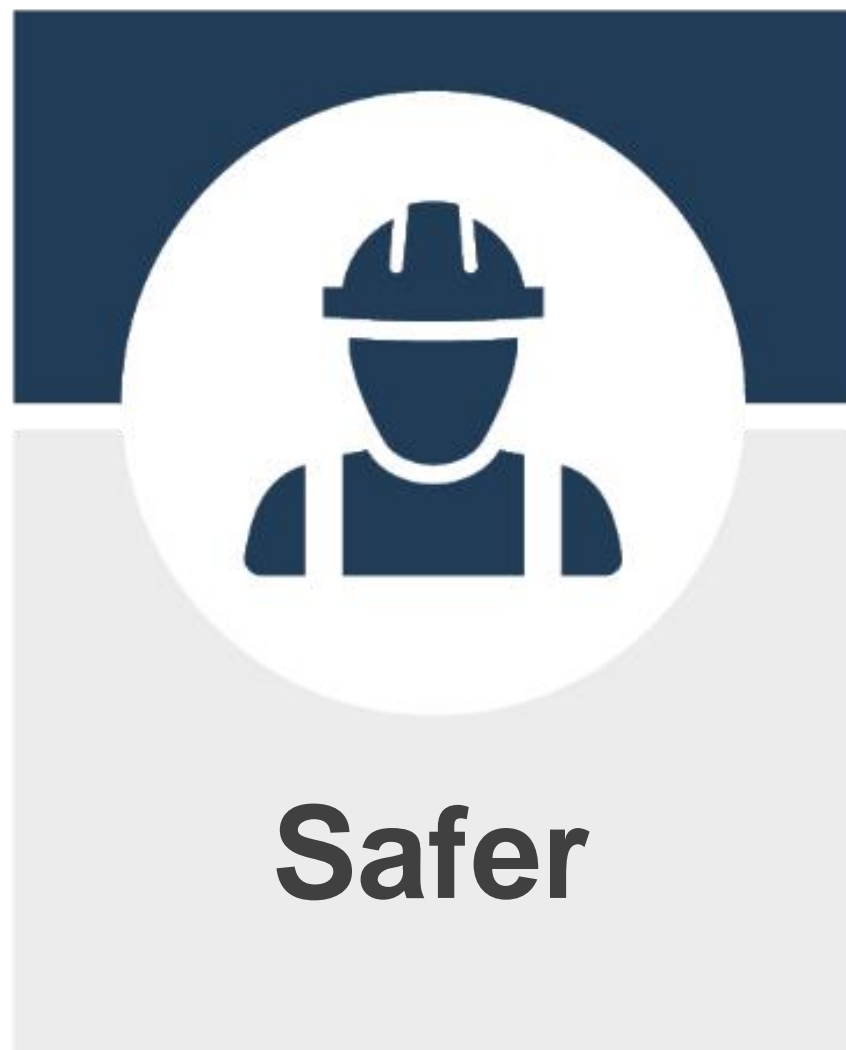
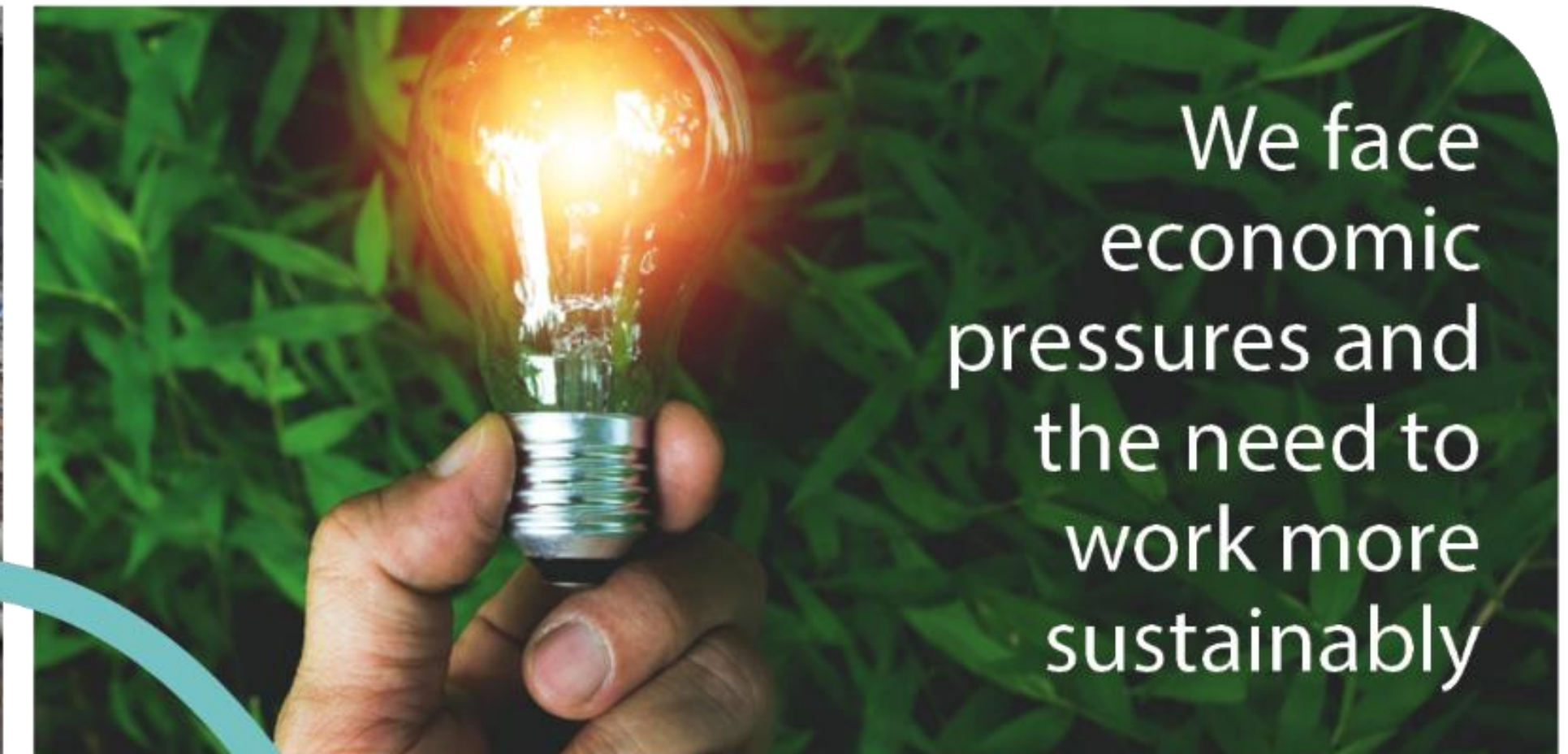



Manufacture M&E building services solutions for the construction industry



Offer customisable and engineered solutions to meet the demands of our clients



Manufacture the highest quality products in a clean and productive facility



Innovate through product development



Building

AWARDS

2019

Specialist Contractor
of the Year

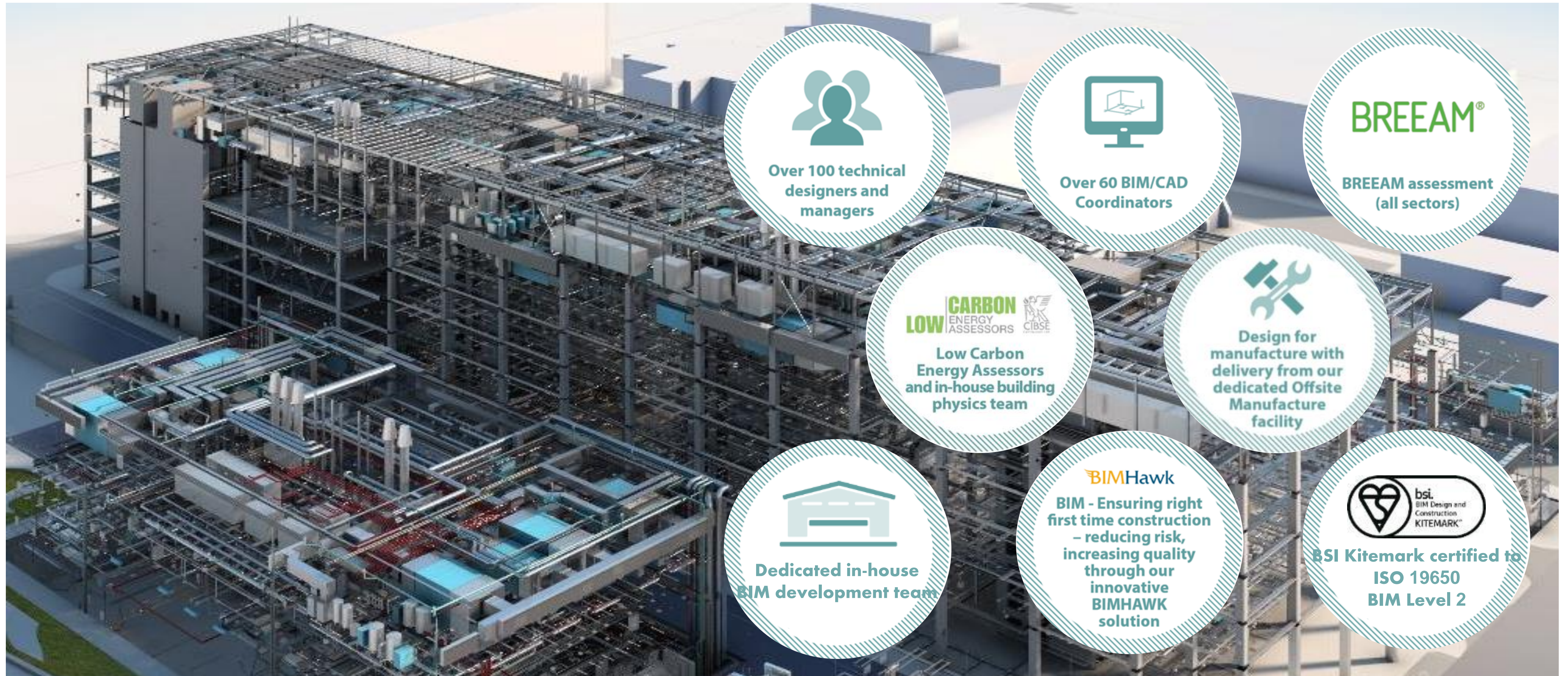

 <p>Better health and safety on site</p>	<p>RIDDOR Free since 2011</p> <p>Over 1.3m hours RIDDOR free</p>	 <p>Reduces environmental impact – minimal waste</p>	 <p>Enhances product quality</p>
 <p>Improved Programme Security</p>	 <p>Minimises onsite disruption</p>	 <p>Improve productivity – onsite and offsite</p>	 <p>Provide engineered complex solutions</p>





Fast-paced project



Innovative

Bridge service
structure



Innovative & practical

Horizontal multi-service
modules which enable 56m to
be installed every day



Time

Removes more than
17,500 hours of work
away from site

Nearly **10%** of project
value is through
offsite – **offsite is
circa £7m**

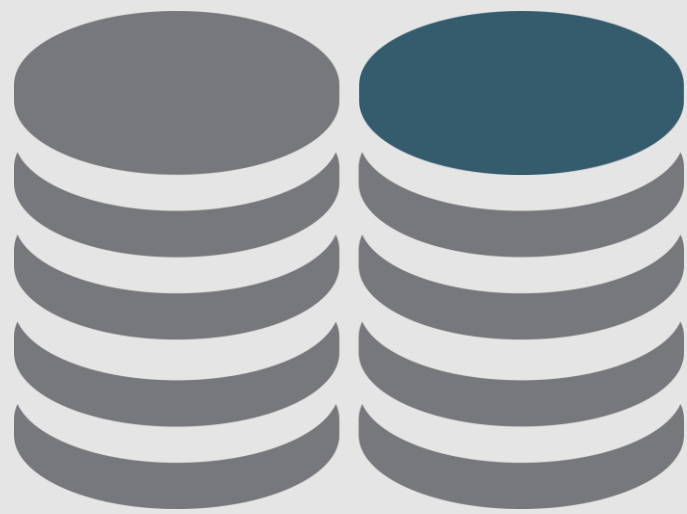



**Using our
dedicated in-
house BIM
team to
streamline
the design
process**



**Developing a
standard
catalogue of
component
parts –
quicker and
more cost
effective**



**Modelled in
Revit then
automation
software
creates
production
drawing**

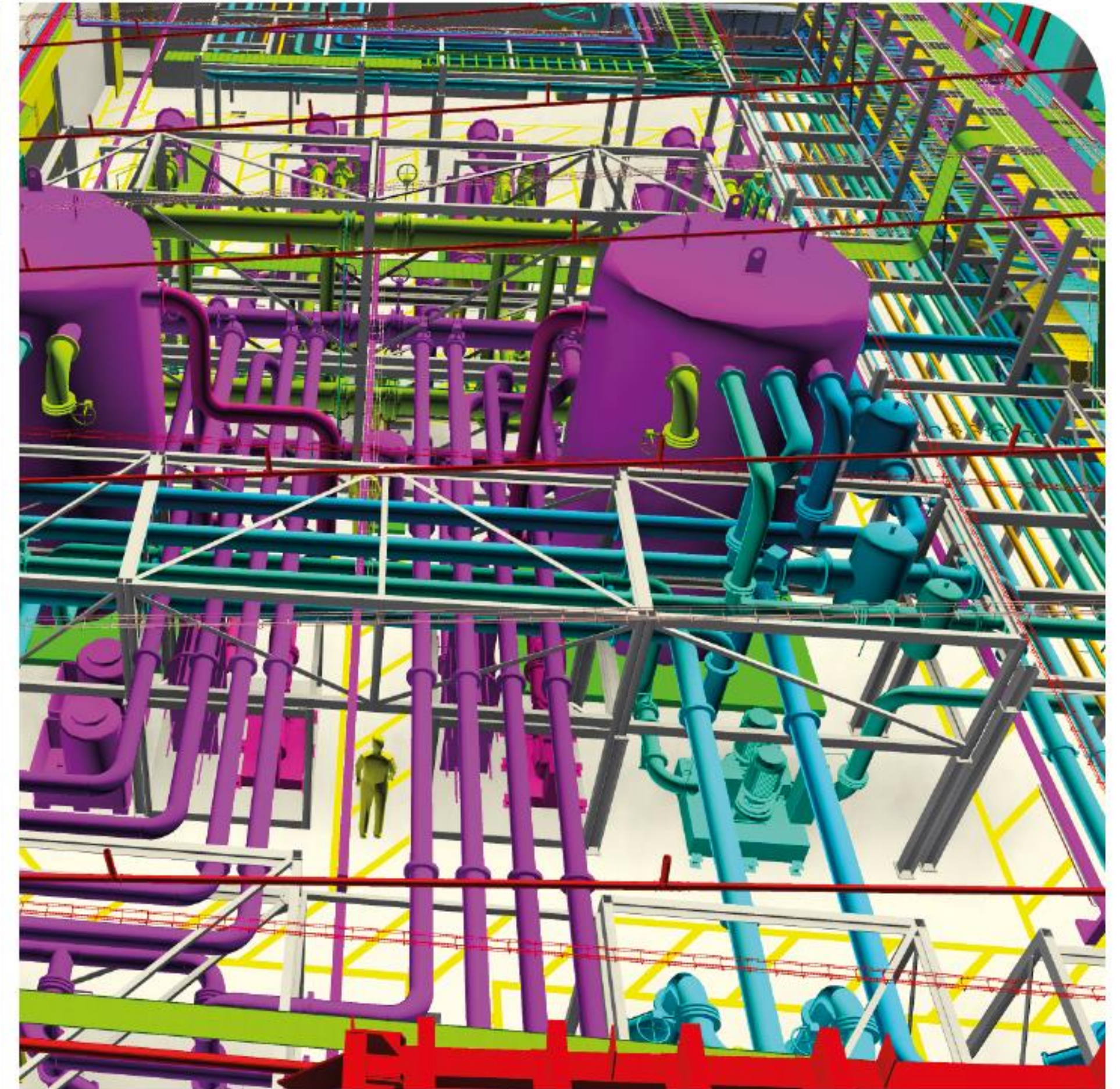

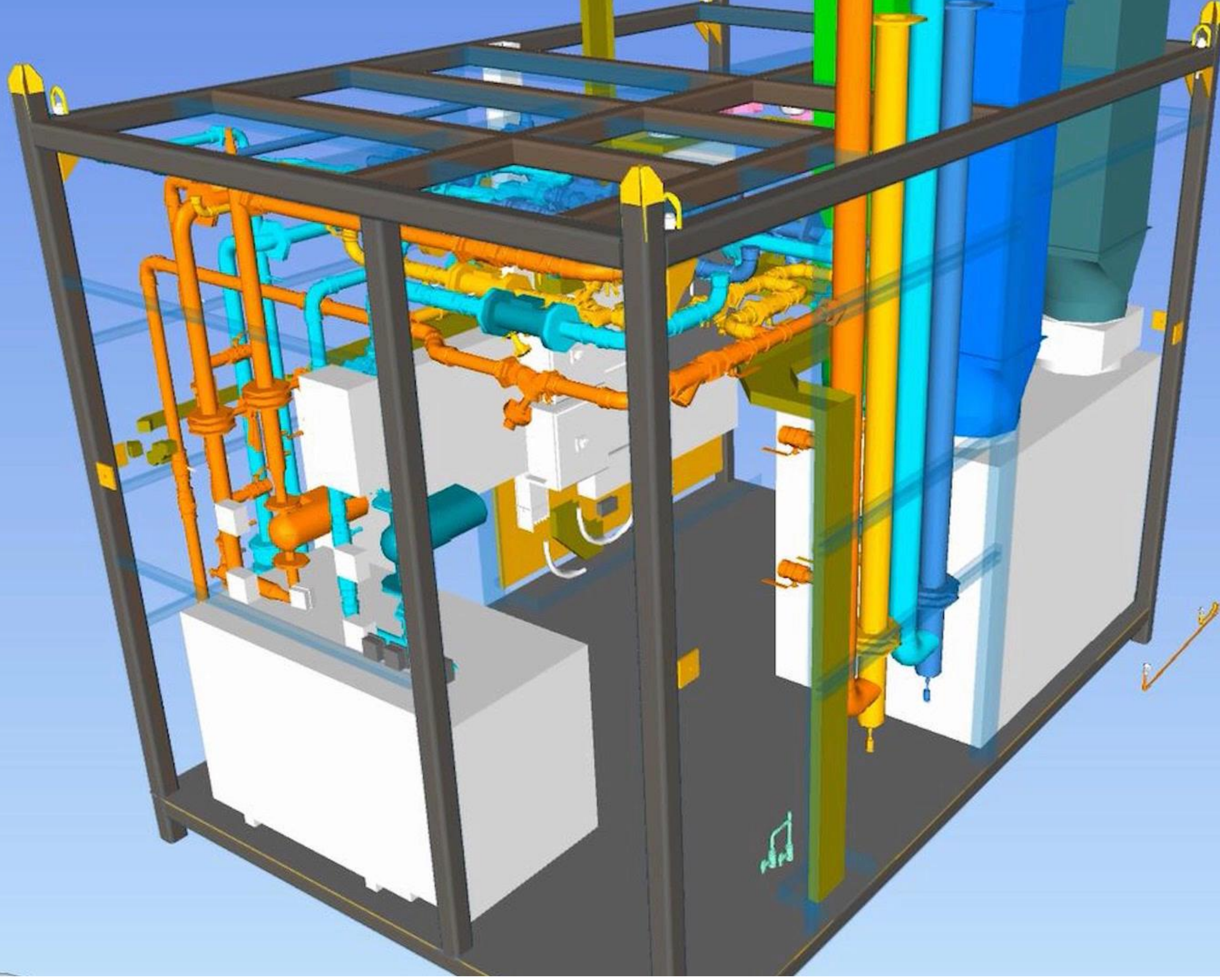



NG Bailey

QUESTIONS?

