

# Factory in a Box

John Dyson – 26<sup>th</sup> April 2016

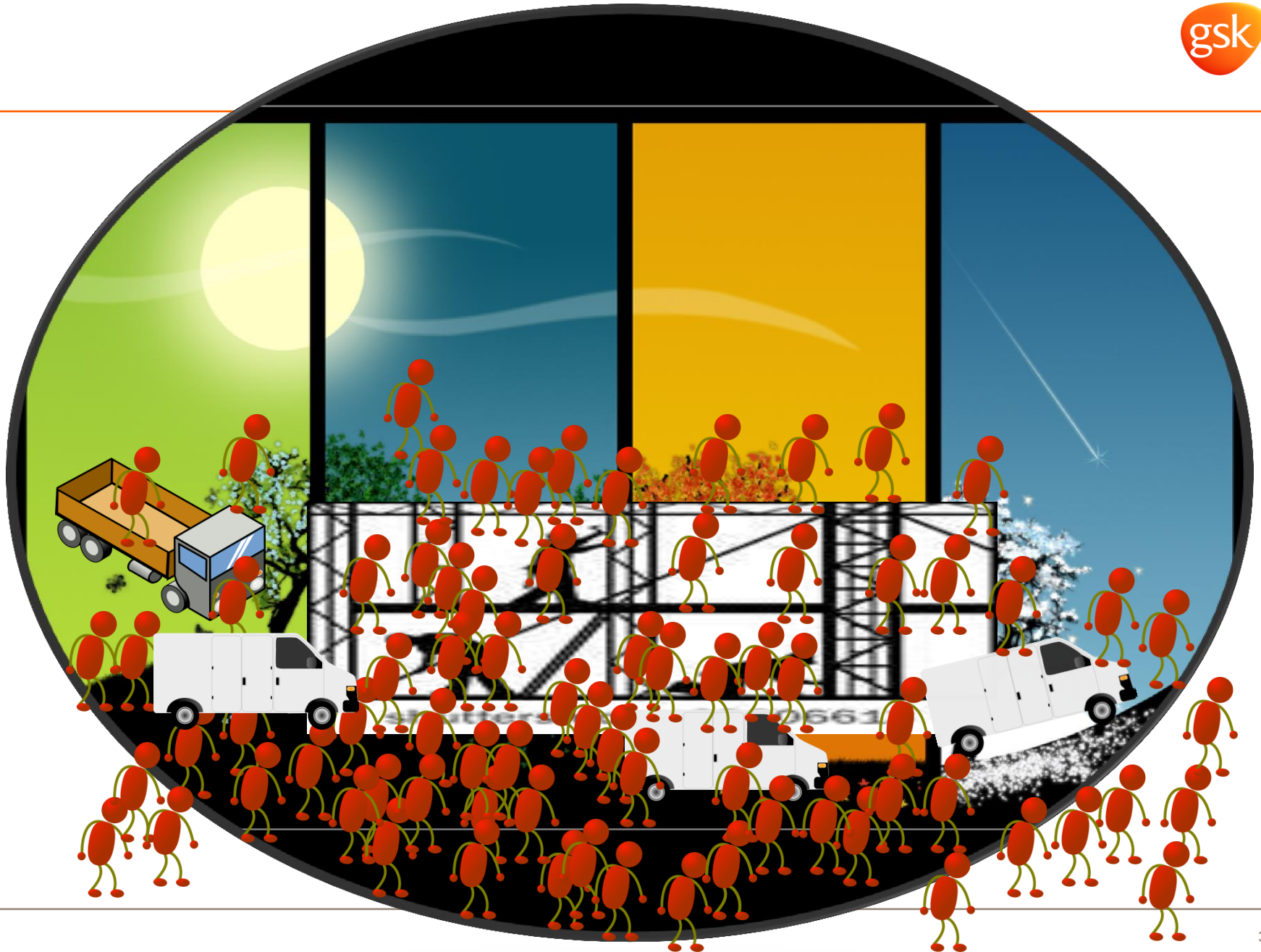



# Break a Factory down into its component parts



S 346 sqm



M 510 sqm

Rapid  
Design  
Optioneering

L 988 sqm

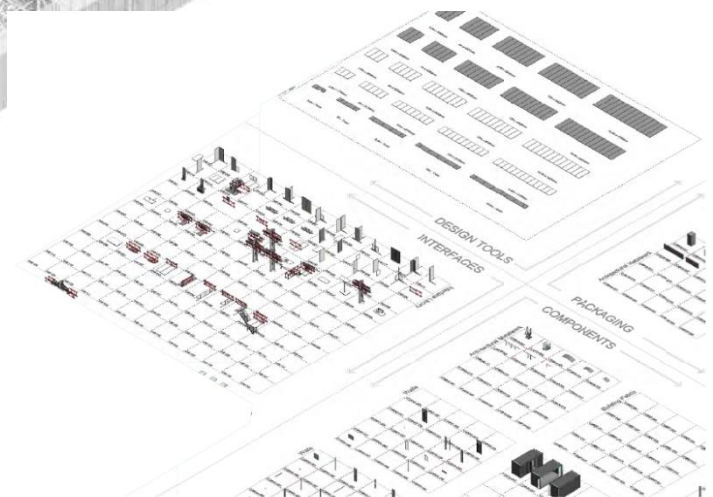
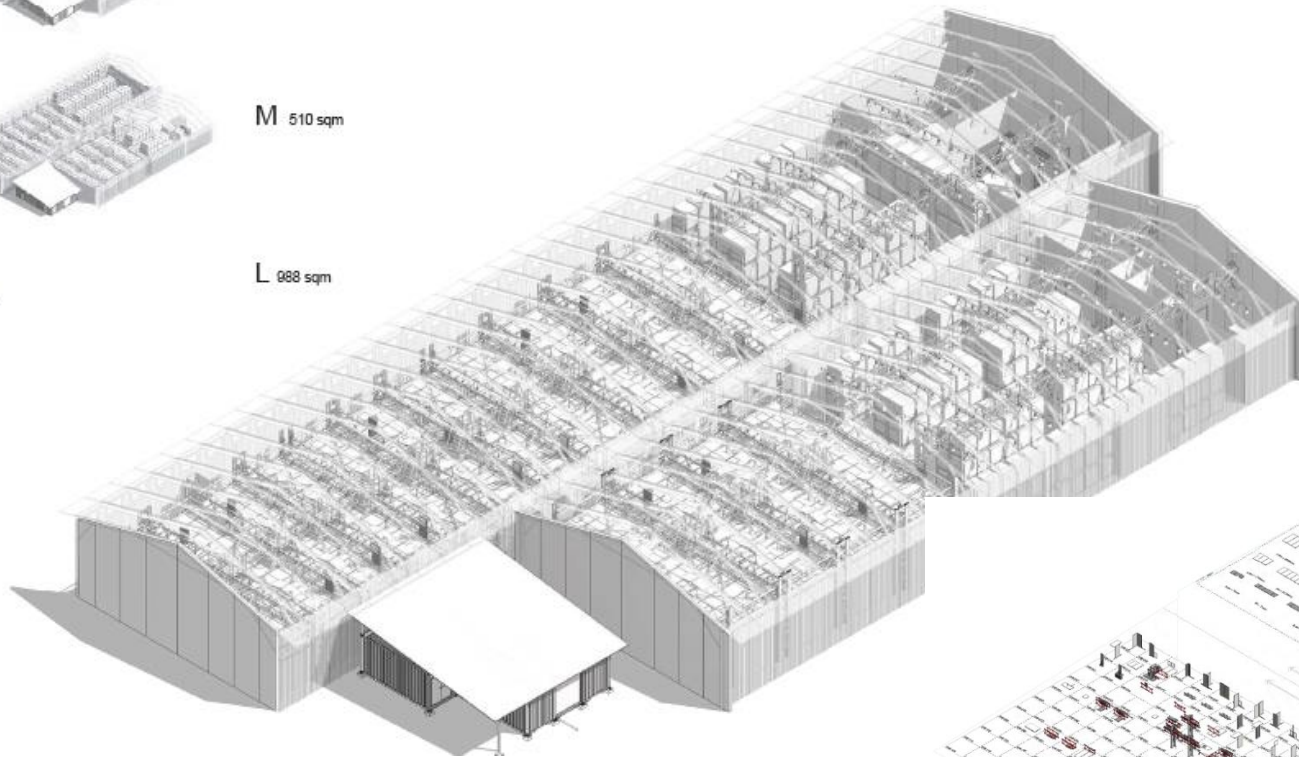

# Set some Rules and Aspirations



No working at height



No trades

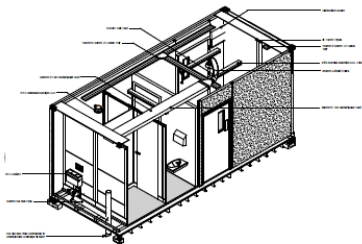

Everything arrives in a Container

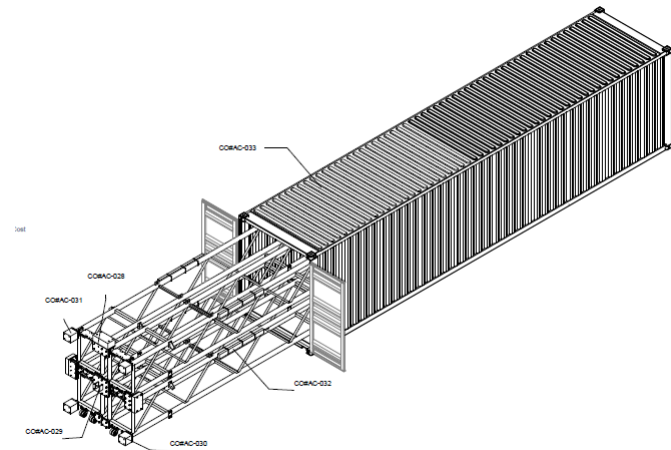



# Engage with Supply Chain and design a solution

# EasiSpace Crown

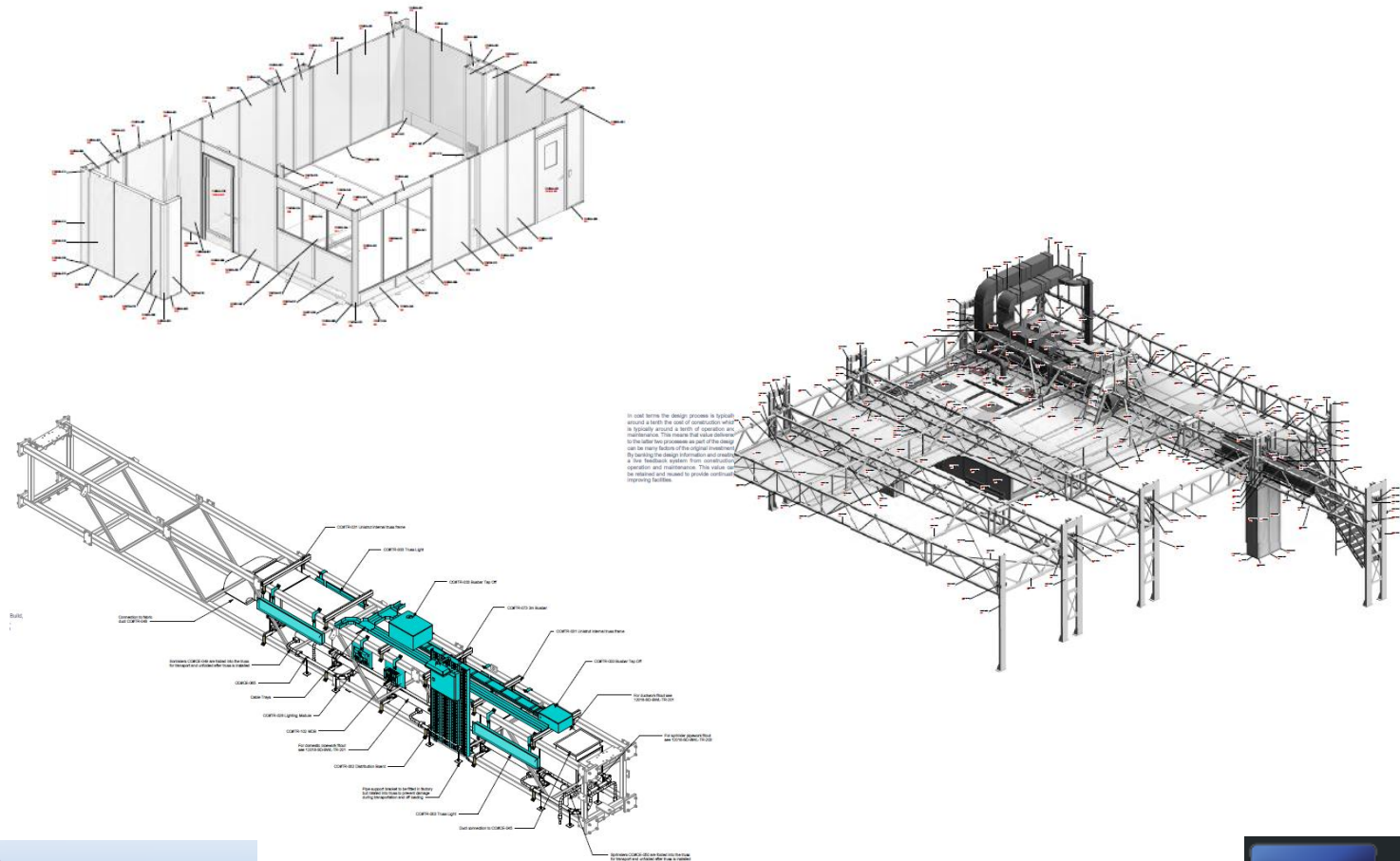



# Develop a construction methodology – poka-yoke

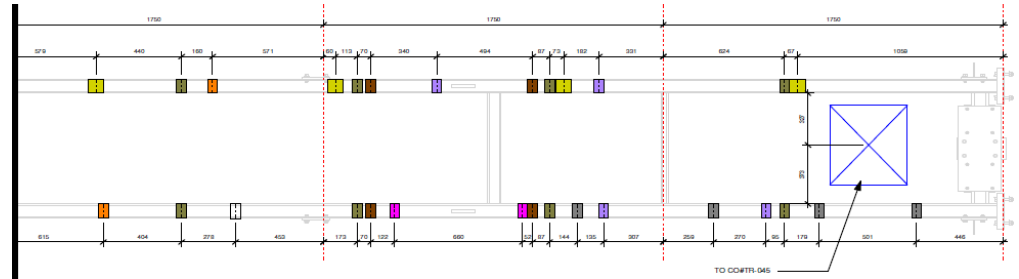

Component colour coding

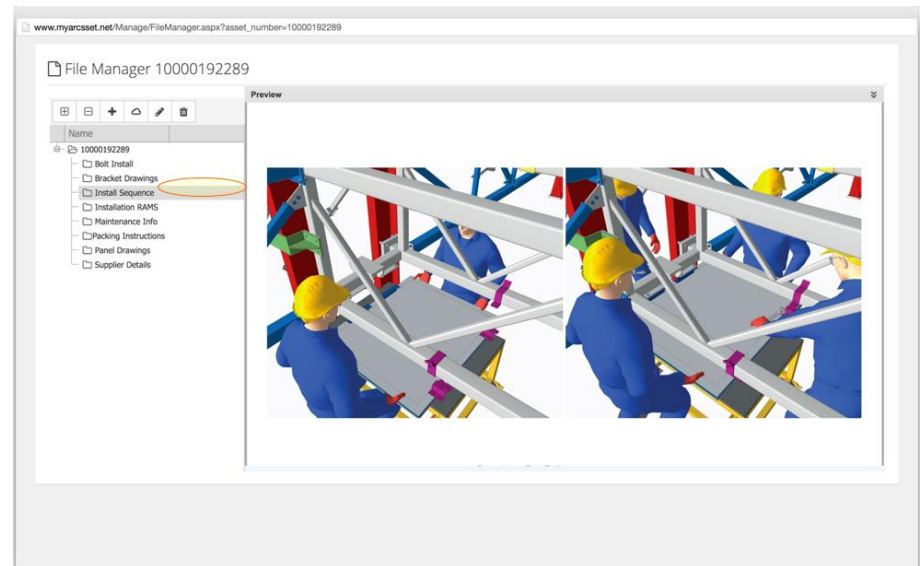

4D constructability studies

# Tracking all components through the supply chain

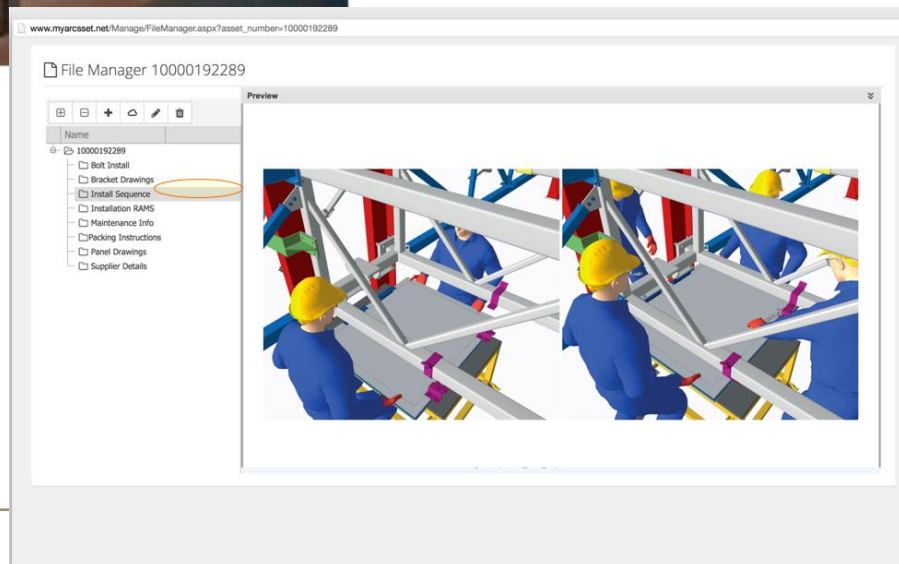
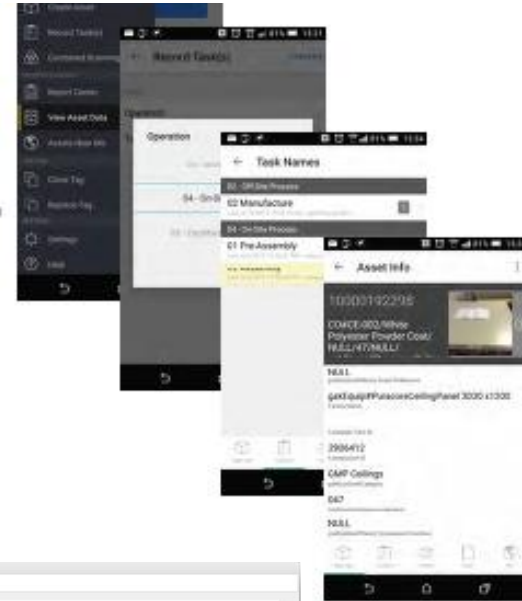

Linking each component with product history and installation detail.



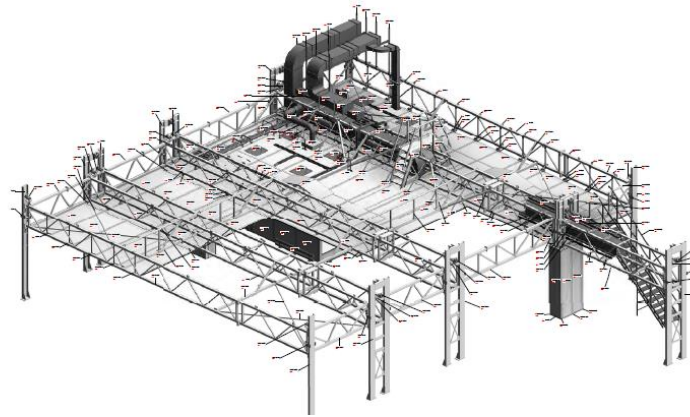

Factory in a  
Box

Beta Build  
May 2015



# Five ex-Gurkhas Five Weeks

**83% Productivity**

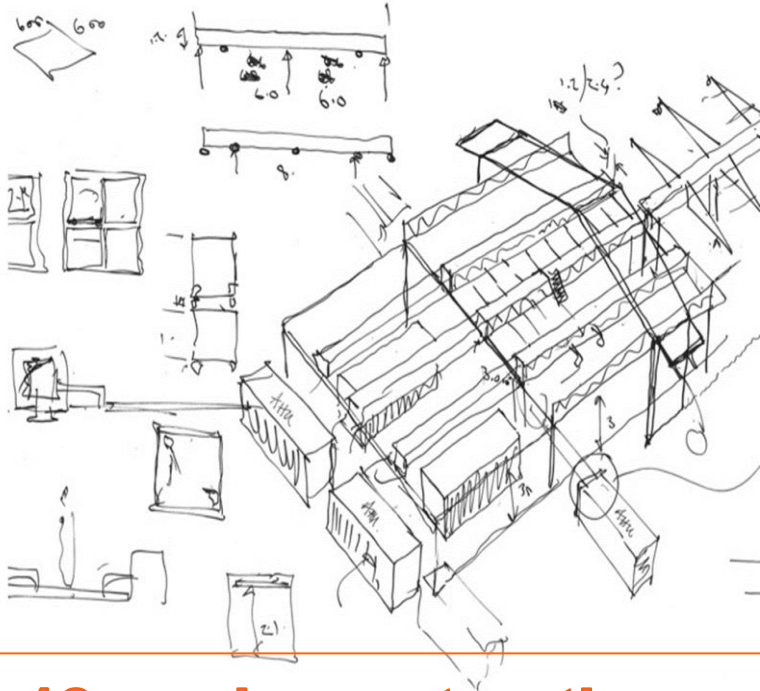

**12 week construction**

**Within 10% of  
emerging market cost**





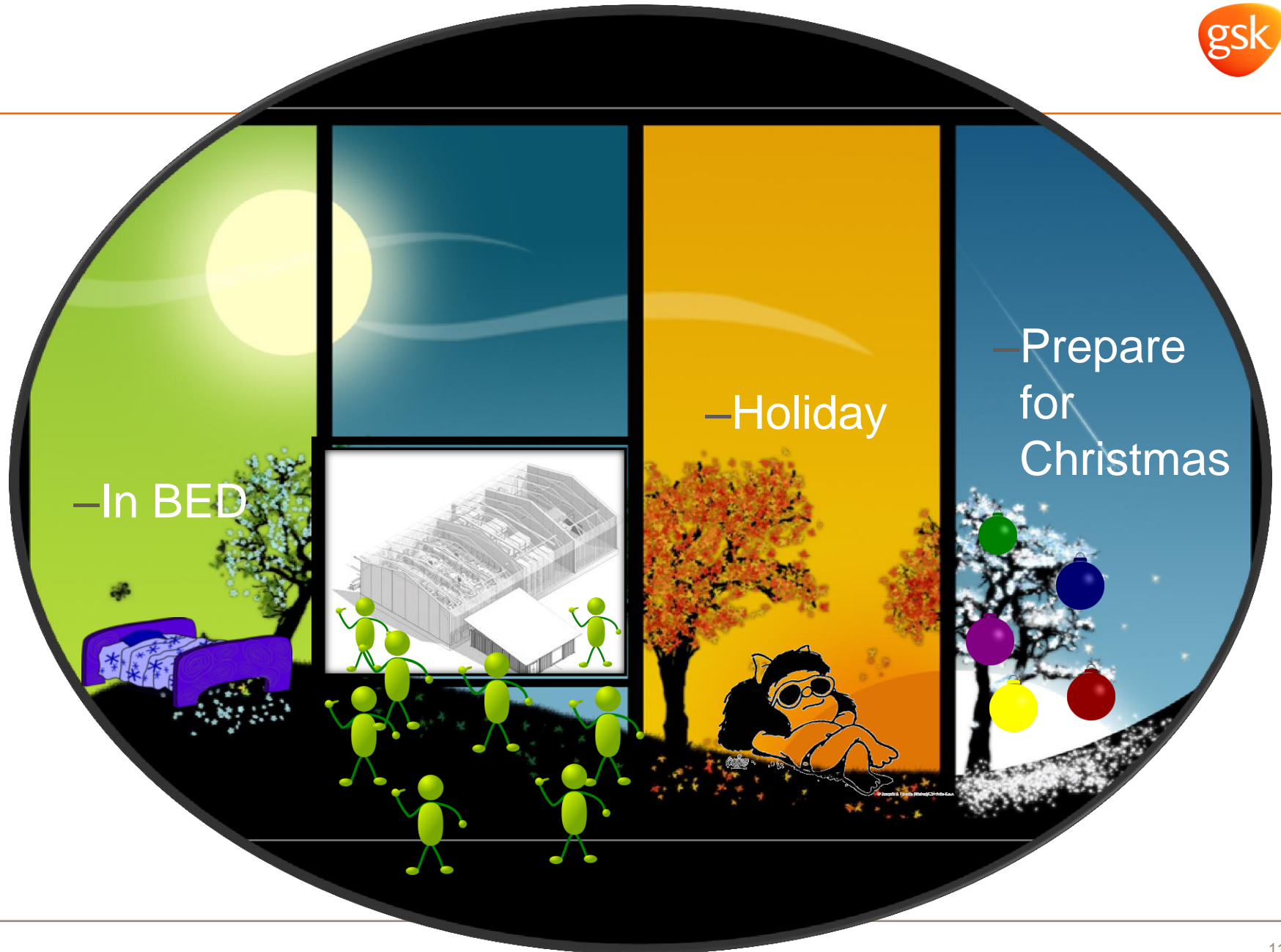

# Factory in a Box

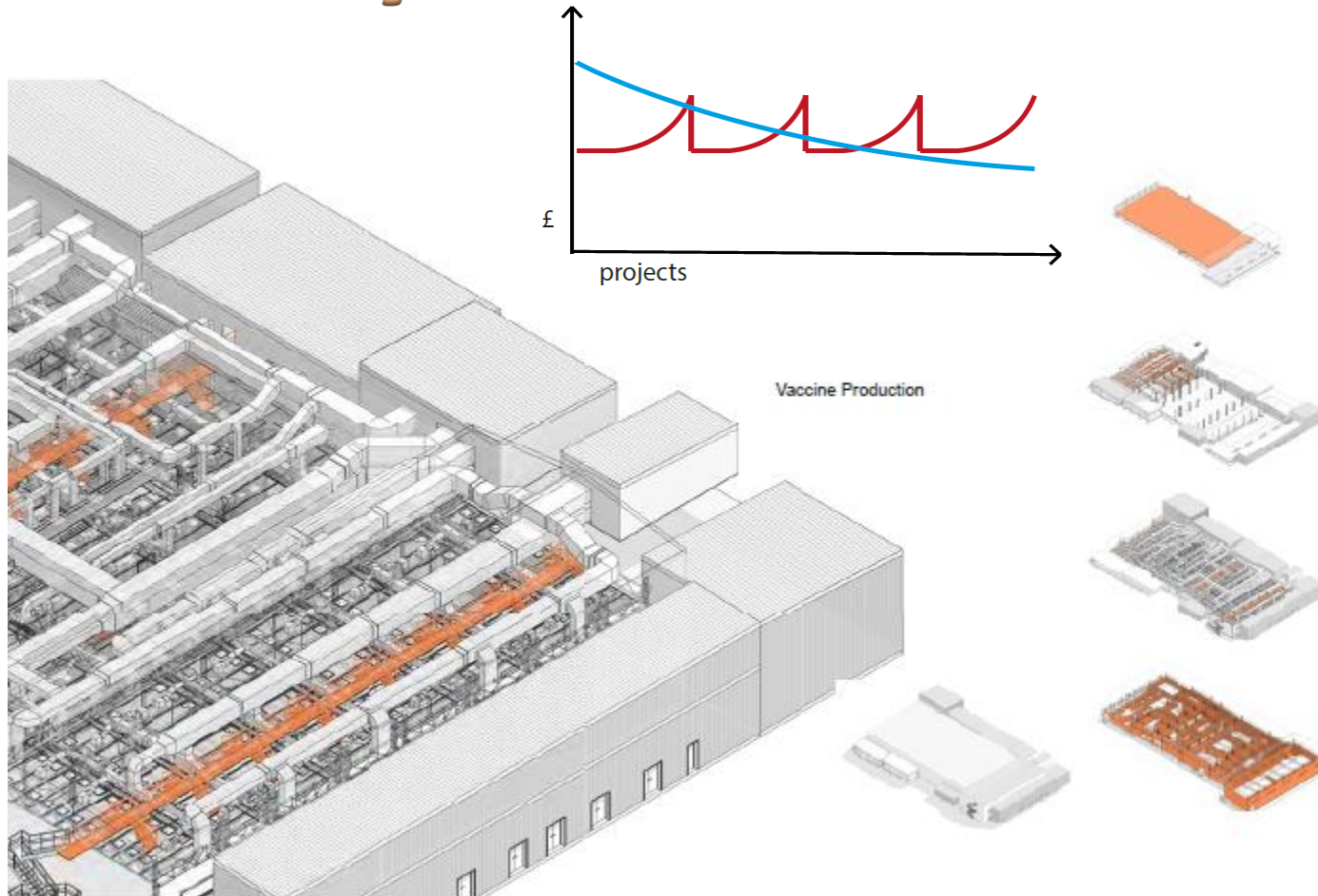

the Future of Construction - now

